

# Keg Line Cleaning

## Operating Instructions

### In the event of a blocked line signal check that:

- The coupling is connected to the Beer Piper ring main
- The drainage pipe is free of kinks
- The beer tap is open
- The sparkler has been removed from the tap
- The gas and assist pump are turned off

### Programme options

Default Clean (10 mins)

One Line Only (7½ mins)

Extended Clean (25 mins)

### Selection

Multi tap (One Product)

Single tap (Inc Super Clean\*)

\* **Super Clean** does not increase programme time. It injects extra chemical and can be used with Multi tap or Extended Programmes.

Our customers may obtain Beer Piper Clear or Beer Piper Purple beer line cleaning fluid from us at a preferential price..

You can order via our website [beerpiper.co.uk](http://beerpiper.co.uk) or by calling us on reephone **0300 303 2709**

### CAUTION

Always wear protective gloves and goggles when handling beer line cleaning fluid

[beerpiper.co.uk](http://beerpiper.co.uk)

### Prep in the Cellar

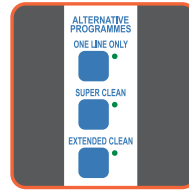

SELECT the cleaning programme required

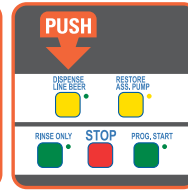

TURN OFF Gas

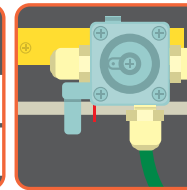

DISCONNECT Keg and DE-GAS

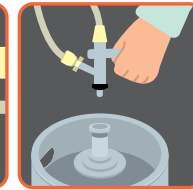

CONNECT to BP Ringmain

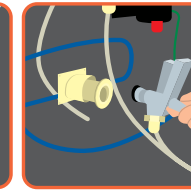

Ensure that the Fob is full

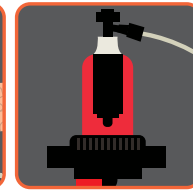

### At the Bar



Sell line beer

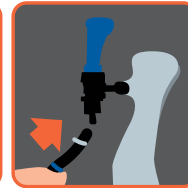

CONNECT Waste to Tap

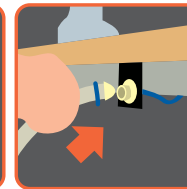

PLUG-IN Waste

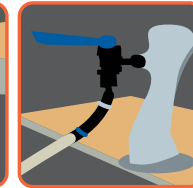

OPEN Tap

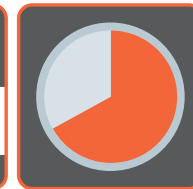
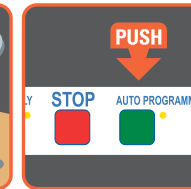

Line Clean in Progress

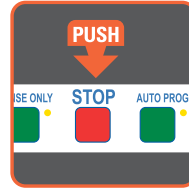

After the beep

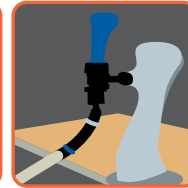

CLOSE Tap

### Back in the Cellar

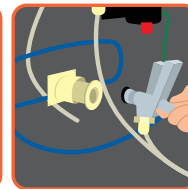
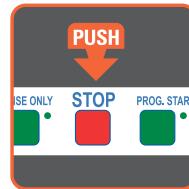

DISCONNECT from BP Ringmain

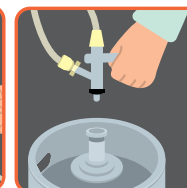

CONNECT Keg

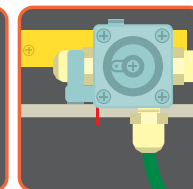

TURN ON Gas

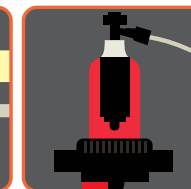

Fill Fob with beer

### Finishing up at the Bar

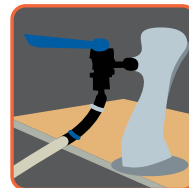

OPEN Tap until beer appears

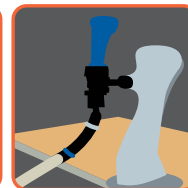

CLOSE Tap

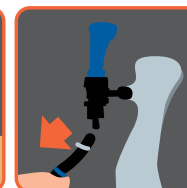

DISCONNECT Waste from Tap

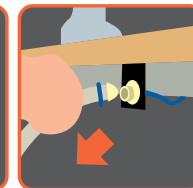

UNPLUG Waste and rinse pipe



Serve beer